

| REV | ECN No. | DESCRIPTION | DATE       |
|-----|---------|-------------|------------|
| A   |         | RELEASE     | 2014-12-10 |
| B   |         | 料号变更A-V     | 2016-4-10  |

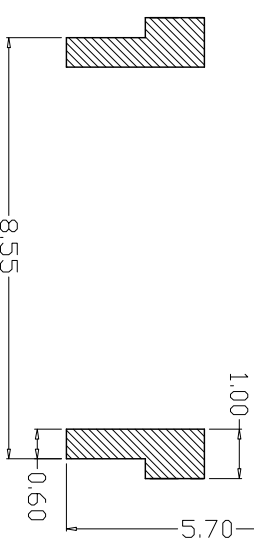
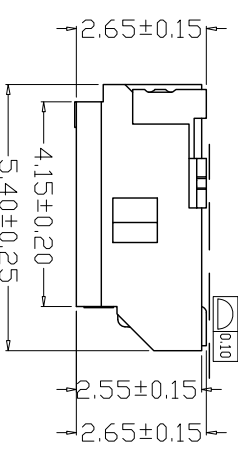
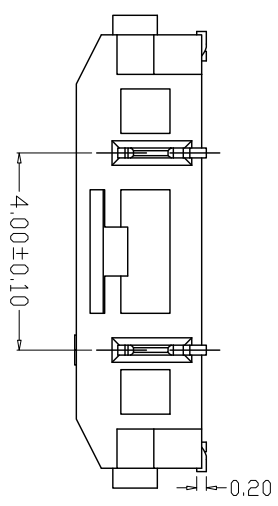
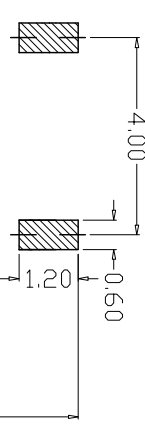
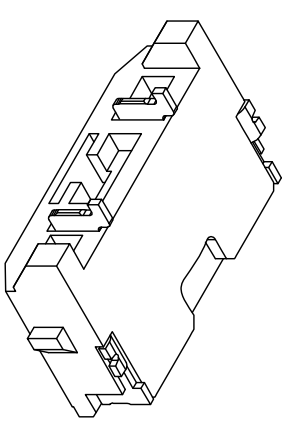
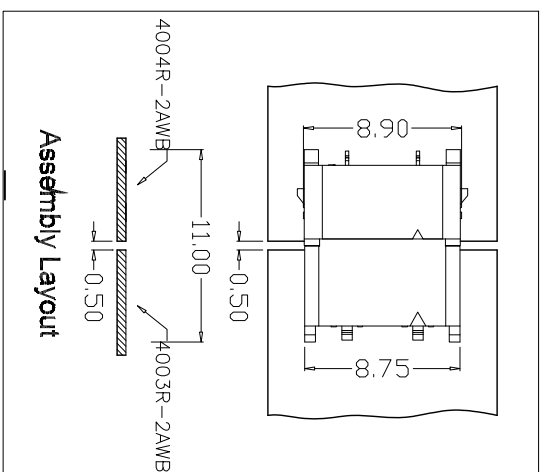
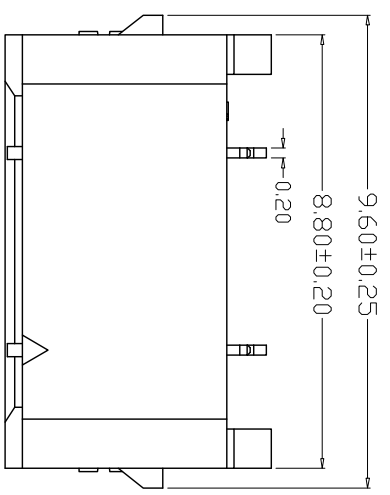

### PCB LAYOUT

- Specifications :**
- Voltage rating: 300V AC/DC
  - Current rating: 3A AC/DC
  - Withstanding voltage: 1700V AC/minute
  - Temperature range: -55°C~+105°C
  - Insulation resistance: ≥1000MΩ
  - Contact resistance: ≤20mΩ
  - After environmental testing: ≤40mΩ

| ITEM | COMPONENT | QTY   | MATERIAL      | FINISH                      |
|------|-----------|-------|---------------|-----------------------------|
| 3    | PAD       | 2 PCS | COPPER ALLOY  | NI:30u"-100u",Sn:80u"-200u" |
| 2    | CONTACT   | 2 PCS | COPPER ALLOY  | NI:30u"-100u",Sn:80u"-200u" |
| 1    | HOUSING   | 1 PCS | THERMOPLASTIC | UL 94V-0, COLOR:NATURE      |

|   |                       |                 |  |
|---|-----------------------|-----------------|--|
| 深圳市德全盛电子科技有限公司  |                       | TITLE: ASSEMBLY |  |
| SHENGZHENG CITY DEQUANGSHENG ELECTRONIC TECHNOLOGY CO.,LTD. |                       | BTB-CONNECTOR   |  |
| USE: CUSTOMER   | PART NO.: 4.0B-1-2YWB |                 |  |
| APPD: XINZHONG  | DWG NO.: 001          |                 |  |
| CHKD: GUILI   | SCALE 1:1             |                 |  |
| DR: KANGJING  | SHEET SHEET           |                 |  |

1 2 3 4 5 6 7